

M-FLEX 2X2 CAN SPLITTER

The 2x2 CAN Splitter is engineered to deliver robust and efficient data for OEM systems. Designed with four four-pin Deutsch connectors, this assembly simplifies CAN communication while simultaneously providing power and ground connections in a compact, reliable package.



M-Flex
CONTROLLERS

IP67

12V
24V

RoHS
Compliant



FEATURES



Four four-pin Deutsch DT style connectors.



Fast and reliable CAN messaging.



Delivers voltage and ground connection.

SPECIFICATIONS

Specifications subject to change without notice. \ Revised 11.25

Supply Voltage	12V
Max Current	13A
Connectors	Deutsch DT15-12PA and DT15-12PB
Ingress Protection	IP67
Operating Temperature	-40° to 125°C (-40° to 257°F)
Storage Temperature	-40° to 125°C (-40° to 257°F)
Weight	2.4oz (68.03 g)
Dimensions	7.29 in L x 3.01 in W x 0.82 in D (183 mm L x 77 mm B x 21 mm H)

DIMENSIONS

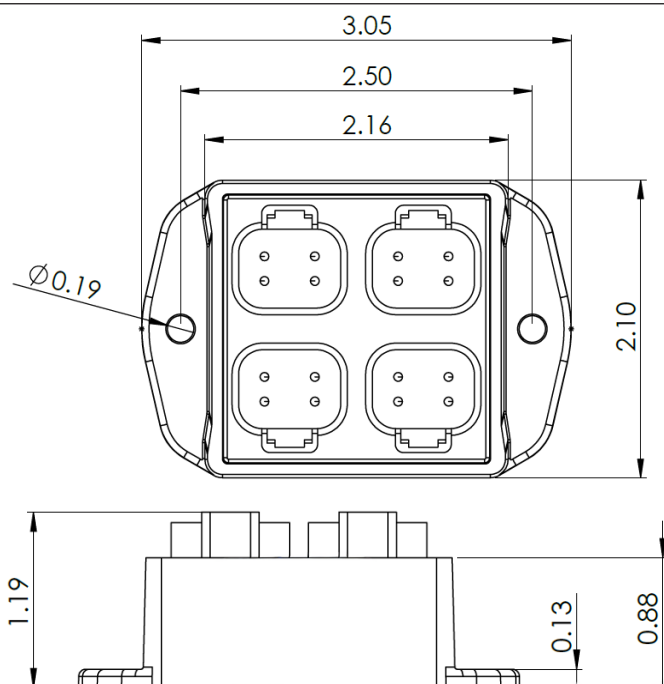

For a detailed specification visit
marlintech.com

Marlin Technologies, Inc.
101 Industrial Drive
Horicon, WI 53032-1803
920.485.4463 | P

MARLINTECH.COM

MADE IN THE USA WITH
IMPORTED MATERIALS